



CENTRAL CATHOLIC HIGH SCHOOL INSTITUTIONAL MASTER PLAN

OCTOBER 30, 2024

CENTRAL CATHOLIC HIGH SCHOOL MISSION



- **FOUNDED IN 1927 AND RECEIVES STUDENTS FROM ALL OVER THE PITTSBURGH AREA**
- **COLLEGE PREPARATORY SCHOOL FOR BOYS GUIDED BY PRINCIPLES OF ST. JOHN BAPTIST de LA SALLE**
- **PROVIDES A CHALLENGING AND DIVERSE PROGRAM OF STUDIES ROOTED IN FAITH**
- **THE CENTRAL CATHOLIC PROMISE: TO INSPIRE BOYS TO BECOME MEN OF FAITH, MEN OF SCHOLARSHIP, MEN OF SERVICE**

CENTRAL CATHOLIC HIGH SCHOOL CAMPUS HISTORY

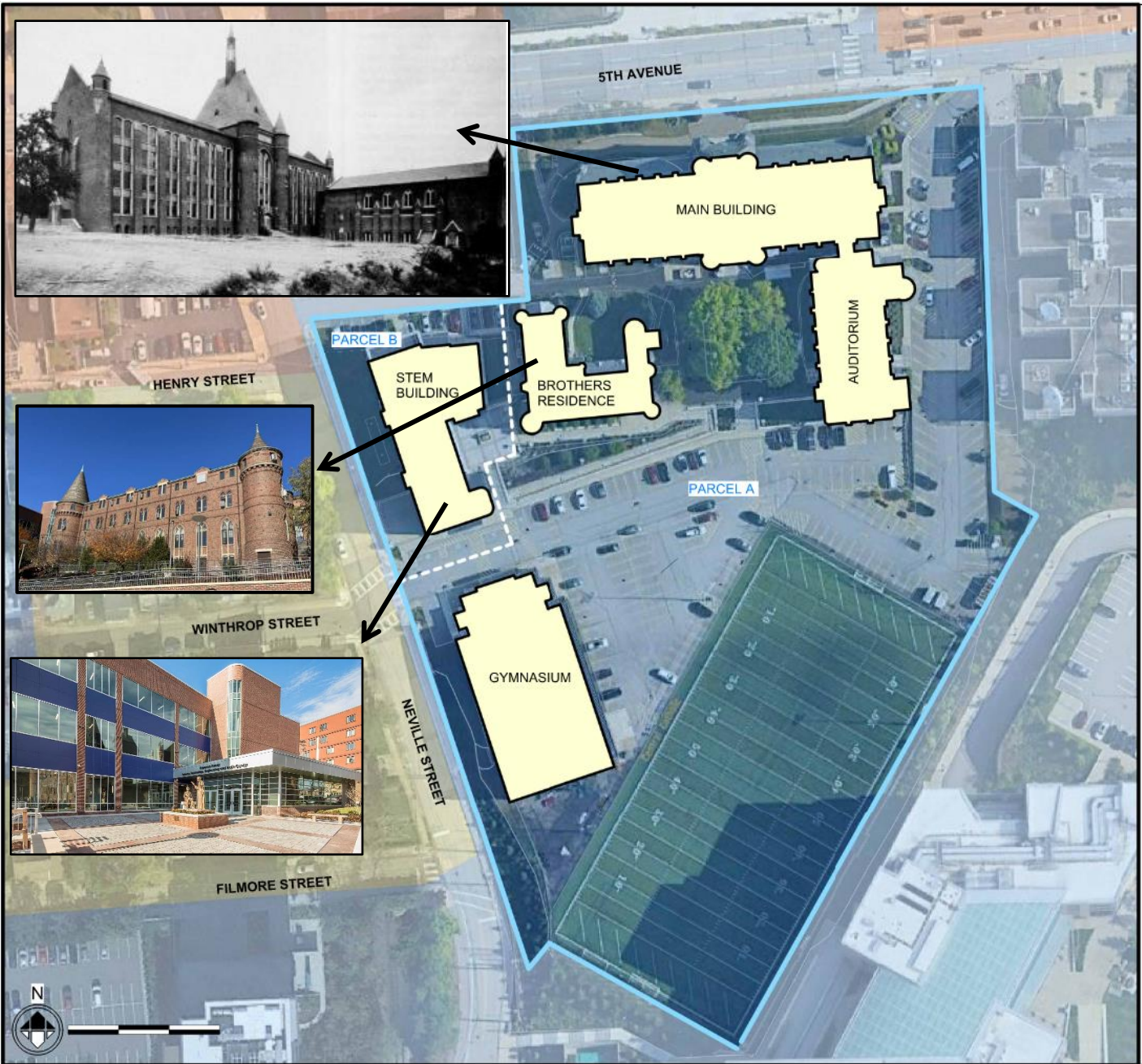

- 1927: MAIN SCHOOL BUILDING OPENED
- 1927: BROTHERS RESIDENCE CONSTRUCTION COMPLETED
- 1978: ALUMNI HALL (GYM) OPENED
- 2000: NEW TURF ATHLETIC FIELD COMPLETED
- 2016: ZUPANIC FAMILY STEM CENTER OPENED
- VARIOUS RENOVATION PROJECTS TO THE MAIN BUILDING THROUGHOUT THE NEARLY 100 YEAR HISTORY

INSTITUTIONAL MASTER PLAN BACKGROUND



- **2017: FEASIBILITY STUDY FOR RENOVATIONS TO THE BROTHERS RESIDENCE BUILDING**
- **2021: CAMPUS MASTER PLAN STUDY**
 - **DEVELOPED BASED ON CCHS STRATEGIC MASTER PLAN AS WELL AS DISCUSSIONS AND MEETINGS WITH KEY STAKEHOLDERS**
 - **KEY FINDINGS / CONCLUSIONS:**
 - **A DESIRE TO RENOVATE THE BROTHERS RESIDENCE BUILDING**
 - **THE NEED FOR A NEW STUDENT CENTER**
 - **THE NEED FOR UPGRADES TO THE MAIN BUILDING AND SITE IMPROVEMENTS**
- **2023-2024: INSTITUTIONAL MASTER PLAN**

INSTITUTIONAL MASTER PLAN GOALS

10-YEAR DEVELOPMENT PLAN GOALS

- **PHASE 1: BROTHERS RESIDENCE**
 - INTERIOR RENOVATION OF BROTHERS RESIDENCE BUILDING INCLUDING HANDICAP ACCESSIBILITY UPGRADES, NEW BEDROOMS FOR BROTHERS, AND ADMINISTRATIVE OFFICES
- **PHASE 2: NEW STUDENT CENTER BUILDING**
 - DEMOLISH EXISTING ALUMNI HALL AND CONSTRUCT NEW STUDENT CENTER BUILDING
- **PHASE 3: MAIN BUILDING UPGRADES & SITE IMPROVEMENTS**
 - HANDICAP ACCESSIBILITY UPGRADES, HVAC UPGRADES, AND SITE SECURITY UPGRADES



INSTITUTIONAL MASTER PLAN – PHASE 1

PHASE 1: BROTHERS RESIDENCE

- **RENOVATE INTERIOR OF THE BUILDING TO PROVIDE:**
 - **NEW BEDROOMS APPROPRIATELY SIZED FOR THE CURRENT COMMUNITY OF BROTHERS LIVING ON CAMPUS.**
 - **HANDICAP ACCESSIBILITY UPGRADES INCLUDING RAMPS AND ELEVATORS**
 - **ADMINISTRATIVE OFFICES ON THE FIRST AND BASEMENT FLOOR.**



INSTITUTIONAL MASTER PLAN – PHASE 2

PHASE 2: NEW STUDENT CENTER

- DEMOLISH EXISTING GYMNASIUM AND CONSTRUCT NEW STUDENT CENTER BUILDING IN THE SAME LOCATION
- NEW STUDENT CENTER BUILDING TO FEATURE A GYMNASIUM, LOCKER ROOMS, WEIGHT ROOM, CAFETERIA/KITCHEN, LECTURE ROOM, CLASSROOM, AND ADMINISTRATIVE OFFICES
- A PEDESTRIAN BRIDGE WILL BE PROVIDED TO ALLOW STUDENT ACCESS TO THE BUILDING WITHOUT GOING THROUGH THE PARKING LOT.
- A PARKING GARAGE WILL BE PROVIDED TO OFFSET THE LOSS OF PARKING SPACES ON CAMPUS.



INSTITUTIONAL MASTER PLAN – PHASE 2

PHASE 2: NEW STUDENT CENTER

- THE EXTERIOR DESIGN WILL UTILIZE CONCEPTS FOUND WITHIN THE EXISTING BUILDINGS TO MAINTAIN THE RICH HISTORIC CAMPUS IDENTITY.



CONCEPTUAL RENDERING



CONCEPTUAL RENDERING



EXISTING MAIN SCHOOL BUILDING

INSTITUTIONAL MASTER PLAN – PHASE 3

PHASE 3: MAIN BUILDING AND SITE IMPROVEMENTS

- **MAIN BUILDING**
 - HVAC IMPROVEMENTS TO 3RD AND 4TH FLOOR
 - NEW ELEVATOR AND HANDICAP ACCESSIBILITY UPGRADES
 - RECONFIGURE OF SELECT INTERIOR SPACES UPON COMPLETION OF NEW STUDENT CENTER
- **SITE IMPROVEMENTS**
 - SECURITY SITE UPGRADES INCLUDING FENCING
 - REPAIRS TO FIFTH AVENUE WALL





QUESTIONS AND COMMENTS

